

# Crown of jets/ Corona de chorros

These nozzles are jet manifolds that combine various tilt angles to produce a variety of water falls at different heights. **This nozzle, on its own, is able to fill both small and large diameter ponds due to the wide range of sizes available.**

Estas boquillas son colectores de chorros libres que se combinan con distintas inclinaciones para conseguir diferentes caídas y alturas. **Esta tobera es capaz de llenar el vaso de una fuente, sea éste de pequeño o gran diámetro, debido a la gran variedad de tamaños existentes.**

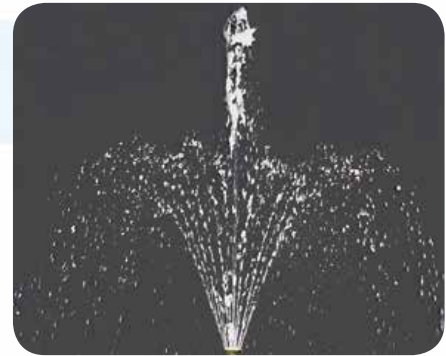

CHROME

ONETECH

Brass/ Latón

Water appearance/ Aspecto del agua

Clear/ Cristalino

Wind resistance/ Resistencia al viento

★★★★☆

Splash/ Salpicadura

★★★★☆

Sound level/ Nivel de sonido

★★★★☆

Visibility/ Visibilidad

★★★★☆

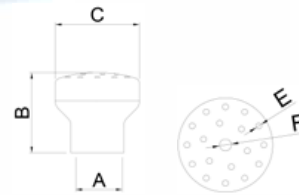
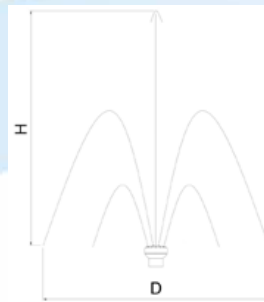

Nozzles/  
Boquillas

| Dimensions/ Dimensiones  |                                |                                      |                                |   |                      | Performance/ Rendimiento                   |      |      |      |      |      |       |
|--------------------------|--------------------------------|--------------------------------------|--------------------------------|---|----------------------|--|------|------|------|------|------|-------|
| Reference/<br>Referencia | Water shape/<br>Forma del agua | Connection/<br>Conexión A<br>BSP-NPT | Length/<br>Long. B x<br>C (mm) | Jets number/<br>Número de<br>chorros (mm) | Weight/<br>Peso (kg) | Spray height/<br>Altura de chorro<br>(m) H | 0,5  | 1,0  | 1,5  | 2,0  | 2,5  | 3,0   |
| F2803419                 |                                | G3/4" F/H                            | 46 x Ø48                       | 6 (Ø3)                                    | 0,29                 | l/min                                      | 8,0  | 11,5 | 16,5 | 21,0 |      |       |
|                          |                                |                                      |                                |   |                      | m.c.a                                      | 1,0  | 1,8  | 2,7  | 3,8  |      |       |
|                          |                                |                                      |                                |   |                      | Diameter (cm) D                            | 130  | 200  | 260  | 310  |      |       |
| F2803421                 |                                | G3/4" F/H                            | 46 x Ø48                       | 6 (Ø3)<br>1 (Ø6)                          | 0,27                 | l/min                                      | 11,0 | 17,5 | 22,5 | 27,5 |      |       |
|                          |                                |                                      |                                |   |                      | m.c.a                                      | 0,6  | 1,1  | 1,7  | 2,2  |      |       |
|                          |                                |                                      |                                |   |                      | Diameter (cm) D                            | 65   | 150  | 200  | 240  |      |       |
| F2803432                 |                                | G3/4" F/H                            | 46 x Ø48                       | 6 (Ø3)<br>6 (Ø3)<br>1 (Ø6)                | 0,25                 | l/min                                      | 17,0 | 24,5 | 30,7 | 35,0 |      |       |
|                          |                                |                                      |                                |   |                      | m.c.a                                      | 0,6  | 1,1  | 1,7  | 2,2  |      |       |
|                          |                                |                                      |                                |   |                      | Diameter (cm) D                            | 60   | 145  | 200  | 240  |      |       |
| F2803443                 |                                | G3/4" F/H                            | 46 x Ø48                       | 12 (Ø3)                                   | 0,26                 | l/min                                      | 17,0 | 24,0 | 30,0 | 35,0 |      |       |
|                          |                                |                                      |                                |   |                      | m.c.a                                      | 1,2  | 2,2  | 3,4  | 4,8  |      |       |
|                          |                                |                                      |                                |   |                      | Diameter (cm) D                            | 120  | 205  | 270  | 330  |      |       |
| F2803454                 |                                | G3/4" F/H                            | 46 x Ø48                       | 12 (Ø3)<br>1 (Ø6)                         | 0,25                 | l/min                                      | 17,0 | 25,0 | 31,5 | 36,5 |      |       |
|                          |                                |                                      |                                |   |                      | m.c.a                                      | 0,6  | 1,1  | 1,7  | 2,2  |      |       |
|                          |                                |                                      |                                |   |                      | Diameter (cm) D                            | 70   | 125  | 165  | 200  |      |       |
| F2803465                 |                                | G3/4" F/H                            | 46 x Ø48                       | 12 (Ø3)<br>6 (Ø3)<br>1 (Ø6)               | 0,22                 | l/min                                      | 22,0 | 34,0 | 40,0 | 47,5 |      |       |
|                          |                                |                                      |                                |   |                      | m.c.a                                      | 0,6  | 1,1  | 1,7  | 2,2  |      |       |
|                          |                                |                                      |                                |   |                      | Diameter (cm) D                            | 60   | 110  | 150  | 180  |      |       |
| F2801079                 |                                | G1" F/H                              | 69 x Ø84                       | 24 (Ø3)<br>12 (Ø3)<br>1 (Ø6)              | 1,06                 | l/min                                      | 31,0 | 50,0 | 63,0 | 74,0 | 82,0 | 90,0  |
|                          |                                |                                      |                                |   |                      | m.c.a                                      | 0,6  | 1,1  | 1,6  | 2,3  | 2,9  | 3,5   |
|                          |                                |                                      |                                |   |                      | Diameter (cm) D                            | 55   | 100  | 145  | 180  | 210  | 240   |
| F2801081                 |                                | G1" F/H                              | 69 x Ø84                       | 24 (Ø3)<br>12 (Ø3)<br>6 (Ø3)<br>1 (Ø6)    | 1,01                 | l/min                                      | 43,0 | 58,0 | 70,0 | 82,0 | 92,0 | 100,0 |
|                          |                                |                                      |                                |   |                      | m.c.a                                      | 0,6  | 1,1  | 1,6  | 2,2  | 2,8  | 3,2   |
|                          |                                |                                      |                                |   |                      | Diameter (cm)                              | 36   | 80   | 118  | 155  | 190  | 215   |